

KEOFITT SAMPLING BAG™

- designed to collect liquid process samples in a hygienic, safe and efficient way.

regom
instruments

WORLD
PREMIERE



THE KEOFITT SAMPLING BAG™

The brand new single-use Keofitt Sampling Bag™ is designed to collect liquid process samples in a hygienic, safe and efficient way.

Its unique and certified design allows an effective sterilization or disinfection of the complete flow prior to sampling to ensure the integrity of the sample.

The samples will be protected from any air-borne or cross contamination, as they are taken into a closed and hygienic system.

Intended for collecting and storing any samples for microbiological and chemical/physical analysis, it is an ideal solution for food/dairy/beverage/brewing applications.



Keofitt Sampling Bag™ 1000ml.



Keofitt Sampling Bag™ 2000ml.

The Keofitt Sampling Bag™ is available in two different sizes: 1000ml and 2000ml.

Keofitt Sampling Bag™ 1L - item no. 151000

Keofitt Sampling Bag™ 2L - item no. 152000

KEY FEATURES:

- single-use multi-layer sampling bag manufactured under clean room conditions
- ready-to-use any time
- effective sterilization/disinfection of the flow path
- suitable for any liquids incl. viscous products and/or products containing solid particles with a size of up to 15mm in diameter
- suitable for ALL Keofitt valves - including W15 and W25 valves
- widely certified (EU EC 1935/2004 - EU EC 2023/2006 - EU EC 10/2011)
- various accessories available

THIS IS HOW IT WORKS



Fig. 1 Connect

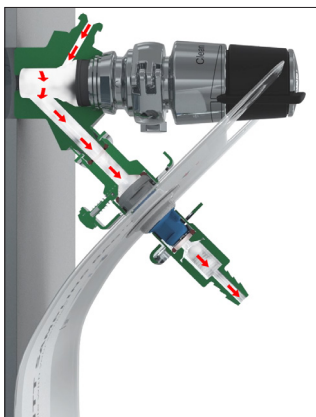

Fig. 2 Clean/Sterilization

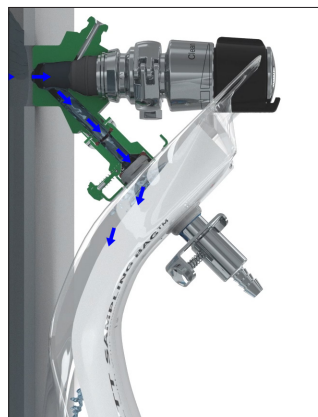







Fig. 3 Sample

1. Remove the seal from the inlet and connect the bag to the valve by using the corresponding fitting.
2. Clean/sterilize the flow path (valve and bag) through the valve inlet.
3. Open the bag and the sampling valve to take the sample.
4. Close the valve and the bag (optional: flush/clean/sterilize again)
5. Remove the bag and bring it to the lab for analyzing the sample.

KEOFITT SAMPLING BAG™ 1000 ml "Patent pending"



ART. NO. 151000

GENERAL

-  The KEOFIT Sampling Bag is the ideal sampling bag solution for any liquid food/dairy application. The unique design provides an effective sterilization/disinfection of the sample flow path to ensure the integrity of the sample. The bag can stand upright when filled.
-  The KEOFIT Sampling bag is a single-use multi-layer sampling bag manufactured under clean room conditions (ISO class 8).
-  The KEOFIT Sampling Bag is intended for collecting samples for microbiological, chemical and/or physical analysis.
-  Designed for sampling of any liquids containing particles with a diameter of up to 15 mm.
-  The KEOFIT Sampling Bag is a single-use product available in the following sizes:
1000 ml (#151000) - 2000 ml (#152000).



FEATURES

-  Compatible with all KEOFIT sampling valves by using one of these quick couplings for connection to the Keofitt Sampling Bag inlet:
#150083 - QUICK COUPLING KSB INLET f/HOSE PIECE
#150084 - QUICK COUPLING KSB INLET 3/4" CLAMP
#150085 - QUICK COUPLING KSB INLET 1" CLAMP
#150088 - QUICK COUPLING KSB INLET 1/2" CLAMP
-  Inlet: white / Outlet: blue
- both protected by a peel-off aluminum foil seal.
- Quick couplings for Keofitt Sampling Bag outlet:
#150082 - QUICK COUPLING KSB OUTLET 3/8" HOSE BARB (CLOSABLE)
#150086 - QUICK COUPLING KSB OUTLET NON-RETURN-VALVE
- Caps for Keofitt Sampling Bag inlet and outlet:
#150061 - QUICK COUPLING KSB OUTLET ST. STEEL PLUG
#150062 - QUICK COUPLING KSB INLET ST. STEEL PLUG

CERTIFICATION

- Bag (constant sample contact): EU1935/2004 • 2023/2006/EC • EU 10/2011 • FDA 21CFR177.1520 • FDA 21CFR177.1500 (outer layer)
- Inlet / Outlet: EU1935/2004 • 2023/2006/EC • EU 10/2011 • FDA 21CFR177.1520
- O-ring: FDA 21CFR177.2600

TECHNICAL DATA

Material

- Bag: Polypropylene (OPA 15 / 100 PP)
- Inlet / Outlet: Polypropylene (Purell HP671T)
- O-ring: Silicone, red (#150820, #150859)

Pressure & Temperature

- Process pressure: Depending on sampling valve. Avoid overfilling the bag.
- Product temperature: Up to 80 °C / 176 °F
- CIP pressure: Max. 5 bar / 72 psi
- SIP temperature: 121 °C / 249 °F (recommended)

Net Weight

- kg/lbs: 0.022 kg / 0.049 lbs

STORAGE AND SHELF LIFE



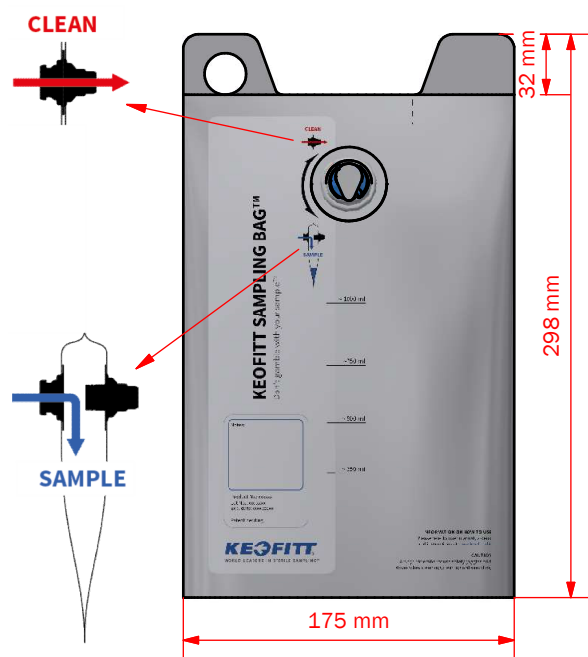

The Keofitt Sampling Bag should be stored in dry storage areas between 15-25 °C, 40-70% humidity and should always be kept out of direct sunlight and away from any source of artificial ultraviolet light. Store in dry and dust free areas in the original packing for as long as possible. Shelf life: 3 years from production.



KEOFITT SAMPLING BAG™ 2000 ml "Patent pending"



ART. NO. 152000

GENERAL

-  The KEOFIT Sampling Bag is the ideal sampling bag solution for any liquid food/dairy application. The unique design provides an effective sterilization/disinfection of the sample flow path to ensure the integrity of the sample. The bag can stand upright when filled.
-  The KEOFIT Sampling bag is a single-use multi-layer sampling bag manufactured under clean room conditions (ISO class 8).
-  The KEOFIT Sampling Bag is intended for collecting samples for microbiological, chemical and/or physical analysis.
-  Designed for sampling of any liquids containing particles with a diameter of up to 15 mm.
-  The KEOFIT Sampling Bag is a single-use product available in the following sizes:
1000 ml (#151000) - 2000 ml (#152000).



FEATURES

-  Compatible with all KEOFIT sampling valves by using one of these quick couplings for connection to the Keofitt Sampling Bag inlet:
#150083 - QUICK COUPLING KSB INLET f/HOSE PIECE
#150084 - QUICK COUPLING KSB INLET 3/4" CLAMP
#150085 - QUICK COUPLING KSB INLET 1" CLAMP
#150088 - QUICK COUPLING KSB INLET 1/2" CLAMP
 -  Inlet: white / Outlet: blue
- both protected by a peel-off aluminum foil seal.
- Quick couplings for Keofitt Sampling Bag outlet:
#150082 - QUICK COUPLING KSB OUTLET 3/8" HOSE BARB (CLOSABLE)
#150086 - QUICK COUPLING KSB OUTLET NON-RETURN-VALVE
- Caps for Keofitt Sampling Bag inlet and outlet:
#150061 - QUICK COUPLING KSB OUTLET ST. STEEL PLUG
#150062 - QUICK COUPLING KSB INLET ST. STEEL PLUG

CERTIFICATION

- Bag (constant sample contact): EU1935/2004 • 2023/2006/EC • EU 10/2011 • FDA 21CFR177.1520 • FDA 21CFR177.1500 (outer layer)
- Inlet / Outlet: EU1935/2004 • 2023/2006/EC • EU 10/2011 • FDA 21CFR177.1520
- O-ring: FDA 21CFR177.2600

TECHNICAL DATA

Material

- Bag: Polypropylene (OPA 15 / 100 PP)
- Inlet / Outlet: Polypropylene (Purell HP671T)
- O-ring: Silicone, red (#150820, #150859)

Pressure & Temperature

- Process pressure: Depending on sampling valve. Avoid overfilling the bag.
- Product temperature: Up to 80 °C / 176 °F
- CIP pressure: Max. 5 bar / 72 psi
- SIP temperature: 121 °C / 249 °F (recommended)

Net Weight

- kg/lbs: 0.022 kg / 0.049 lbs

STORAGE AND SHELF LIFE

The Keofitt Sampling Bag should be stored in dry storage areas between 15-25 °C, 40-70% humidity and should always be kept out of direct sunlight and away from any source of artificial ultraviolet light. Store in dry and dust free areas in the original packing for as long as possible. Shelf life: 3 years from production.

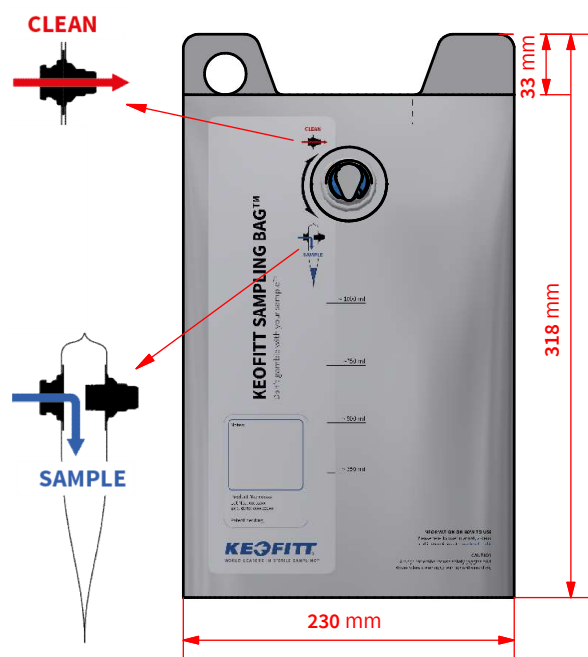



Fittings for the KEOFITT SAMPLING BAG™

INLET

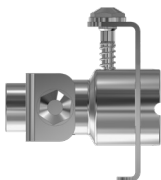

#150083
QUICK COUPLING KSB INLET
FOR HOSE PIECE



#150084
QUICK COUPLING KSB INLET
3/4" CLAMP

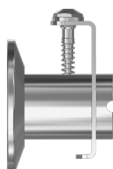

#150085
QUICK COUPLING KSB INLET
1" CLAMP



#150062
QUICK COUPLING KSB INLET
STAINLESS STEEL PLUG



#150088
QUICK COUPLING KSB INLET
1/2" CLAMP

OUTLET

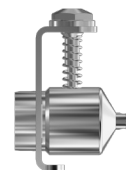

#150061
QUICK COUPLING KSB OUTLET
STAINLESS STEEL PLUG



#150082
QUICK COUPLING KSB OUTLET
3/8" HOSE BARB (CLOSABLE)

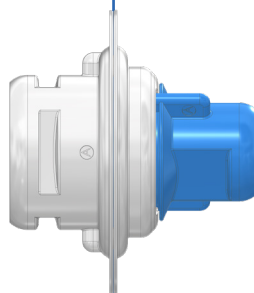



REGOM INSTRUMENTS s.r.o.

Brabcova 1159/2

174 00 Praha 4

CZECH REPUBLIC

Tel: +420 241 402 206

Fax: +420 241 400 290

Mail: regom@regom.cz

Skype: regom-office

www.regom.cz